

Maxview™ Face Shield

Assembly, Operating, and Maintenance Instructions

ENGLISH - LEFRANÇAIS - ESPAÑOL

The Maxview™ is designed to offer maximum face protection coverage, incorporating an extra-large clear polycarbonate window that is available in two options: without anti-fog treatment, or with our premium Sta-Clear® anti-fog coating. The high impact PC window is then framed on the side and chin areas and features an extra-large crown providing maximum coverage and protection with excellent panoramic view. It includes détentes that allow you to lock in both up and down positions. Please read carefully all user instructions and warnings included in this manual.



Surewerx™
Coquitlam, BC V3K 0B3
Telephone: (800) 472-7685
Fax: (604) 523-7693
www.surewerx.com

Surewerx™
Balder d.o.o. Teslova ulica 30,
SI-1000 Ljubljana, Slovenia
www.jacksonsafety.eu

SureWerx™ USA Inc.
Elgin, IL 60123
Phone: (800) 323-7402
Fax: (847) 717-8419
www.surewerx.com/usa

JACKSON®
SAFETY Brand

© Copyright 2020, Surewerx

A / Use / Usa
SureWerx
Brand / Marque / Marca

JA5446_6/2020



WARNING!



For your own protection, read these instructions before using. It is the responsibility of the user to understand the limitations, proper use, care and maintenance of the product. Failure to read these instructions could result in serious injury, including blindness.

This manual is to be removed by the wearer only. Failure to read and follow these instructions and warnings could result in serious injury, including blindness.

Note: Some materials, which may come into contact with the wearer's skin, could cause allergic reactions in susceptible individuals. Contact Surewrx for information. Check with your supervisor to determine whether this face shield and window offers the proper protection for the application. Refer to ANSI Z87.1 or CSA Z94.3 for proper application. Face shields offer limited eye and face protection against common impact hazards, metal chips, particles and sparks. They will not provide extraordinary protection against severe impact hazards such as, but not limited to, fragmenting grinding wheels, high speed projectiles, explosive devices, molten metal or hazardous fluids. Impact resistant windows are NOT unbreakable or impenetrable. Certain Surewrx windows do not meet ANSI Z87.1+ high impact standards and should only be used for basic impact protection as defined by ANSI Z87.1. This product should not be used for protection in any sport related activity or simulated war games. Use the proper IR shaded window when exposed to harmful levels of optical radiation, including burning and cutting. A face shield will not provide any protection against infra-red or ultraviolet radiation unless the window is marked with a shade numeral per ANSI Z87.1 and CSA Z94.3. Do not use for Arc Welding. Not suitable for protection against X-rays, gamma rays, high energy particulate radiation or lasers. Inspect face shield and windows frequently and immediately replace if dull, pitted, scratched or damaged. Chemical contact can cause rapid degradation which severely reduces impact protection. Do not use face shield until a secure fit has been obtained every time. Primary eye protection, as defined by ANSI Z87.1 and CSA Z94.3, must be worn whenever using this product. Do not modify in any way.

1. Inspect the faceshield Window frequently and immediately replace worn, pitted, or scratched Window.
2. If used with CLEAR Window, this Window will NOT provide any protection against ultraviolet or infrared radiation.
3. If used with SHADED Window, DO NOT USE FOR ARC WELDING!
4. This product does NOT conform to ANSI Z87.1 for welding helmets.
5. A Window must be used at all times.
6. Product needs to be used only with appropriate Jackson branded Window and headgear.

Window Removal and Replacement

Window Removal

1. To remove the window, carefully release the window from the bottom chin guard tab. The window should be released towards the outside / front of the face shield. Be cautious not to apply excess force that may break the frame of the face shield.
2. Pull down on the top corner of the window on **one** of the sides to release the corner of the window from the face shield crown. **Be cautious not to apply excess force that may break the frame or tabs of the face shield.**
3. Press the release tab located on the crown of the face shield to release the window. The window can now be removed from the remaining top corner.

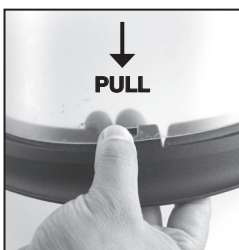

Pull down the top corner of the window on one side only.



Maxview™ Face Shield

Assembly, Operating, and Maintenance Instructions

Window Assembly

1. Insert the top center of the window on to the center of the crown while pressing on the window release tab. The window should secure in place as in image (2)
2. Press the bottom of the window towards the top corner of the crown. The top corner of the window should slide in-to the slot on the side of the face shield. Verify the corner of the window is visible on the inside of the face shield as indicated on image (4).
3. Press the opposite side of the window towards the top corner of the crown as done for the other side. The top corner of the window should slide in-to the slot on the side of the face shield. Verify the corner of the window is visible on the inside of the face shield.
4. Pull the chin guard downwards to place the window between the tabs as indicated on image (6).

1



Insert the center of the window at an angle while pressing the release tab on the crown.

2



3



Push window towards the top corner of the crown.

4

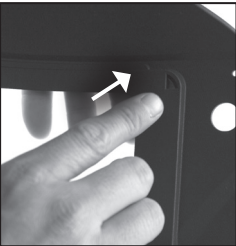

Corner of the window is visible on the inside of face shield.

5



Corner of window is visible on the inside of the helmet.

6

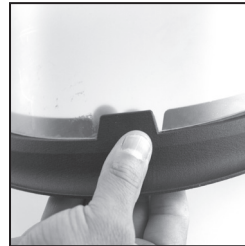

Pull chin guard downwards to insert the window between the tab.

Replacing the Face Shield Headgear

To replace the 370 Faceshield headgear, take the following steps:

1. Remove the Pivot knob on both sides of the headgear.
2. Pull the stud out of the inside of the helmet, then removing all of the Pivot Post, O-Ring and Pivot Stop on both sides of the helmet.
3. Right side assembly – holding the helmet in front of you, with the back facing you, insert the threading stud through the headgear strap, Pivot Post, O-Ring and RH Pivot Stop. Then place this sub assembly into the helmet with the angle adjustment going into the desired hole. Thread the pivot knob on the stud that is now extending through the helmet.
4. Repeat steps above for the left side of the helmet.

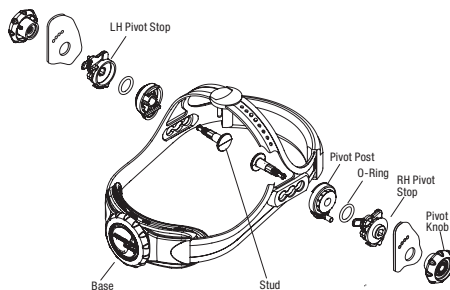

Interchange Welding Helmet System

Helmet Attachment Blades:

- 4-position tilt adjustment allows welder to center the visual field
- Tension knobs allow the welding helmet to be lowered comfortably
- Made from lightweight material that can withstand extreme temperatures of 350°F
- Vertical lock-in eliminates helmet creep securely holding in the upward position
- Approved for use with:
Jackson Slotted front brim hard hats

Interchange Welding Helmet System Instructions

Welding Helmet Attachment and Blades:

1. Hard hat can be worn with the brim forward or backwards. Insert blades into the cap slots with the button always facing the back of the suspension. (Figure 1)
2. Remove the keeper from the latch with a flat screwdriver. Assemble the attachment to the welding helmet. (Figure 2/3)
3. Place hard hat on head. Bring welding helmet towards face and insert attachment posts into the blades. Press firmly on the red knobs inward until a positive click for full engagement.
4. Adjust desired tension with the red knob. Clockwise to tighten. Counter-clockwise to loosen.

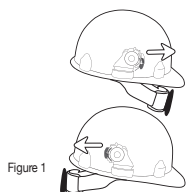

Figure 1

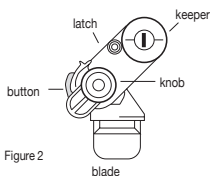

Figure 2

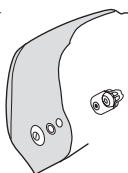

Figure 3